

Update Date : 2016-08-21 Print Date : 2020-02-27

BR07-2

PARKING BRAKE (MODEL: FC)

PARKING BRAKE

DATA AND SPECIFICATIONS

EN06Z0807I200001

Parking brake type	Internally expanding, duo-servo type
Parking brake control type	Lever type control with control cable
Drum inside diameter	254 mm {10.0 in.}
Brake lining	Width x length x thickness 75 mm x 300 mm x 7 mm {2.952 in.} x {11.811 in.} x {0.275 in.}

DESCRIPTION

EN06Z0807C100001

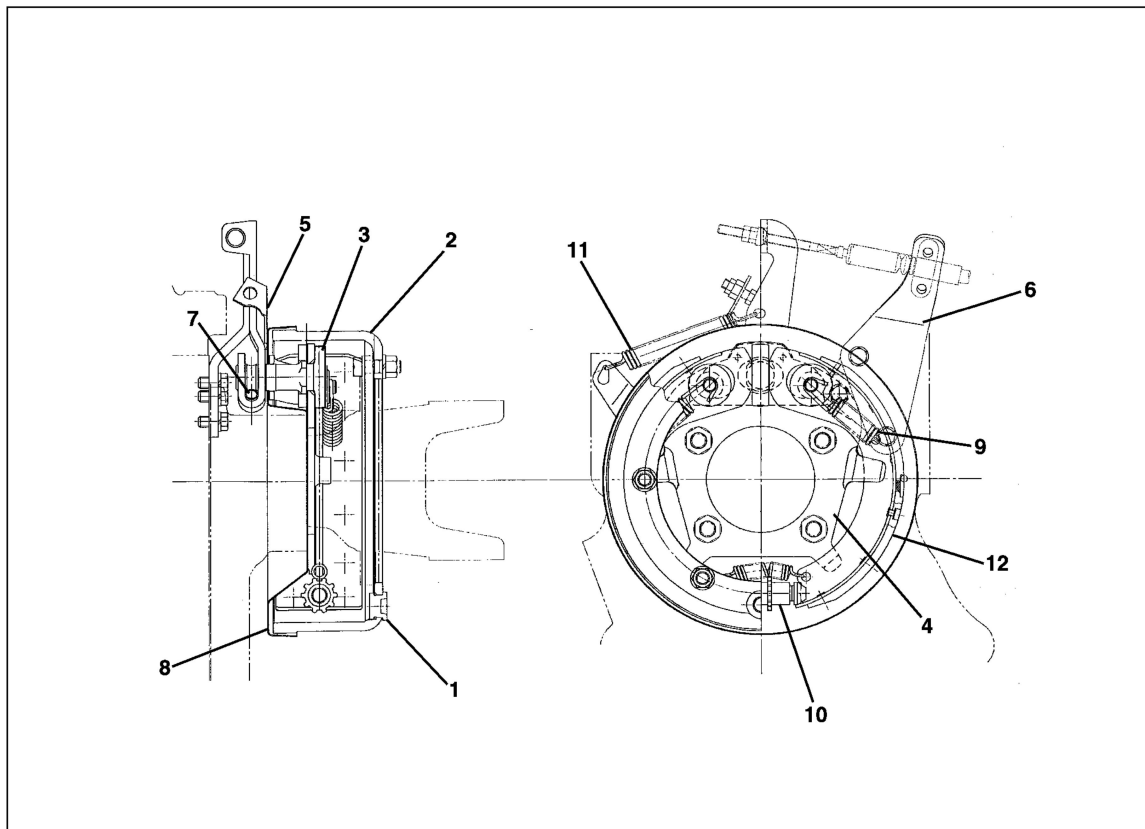

SHTS06Z080700001

1 Grommet	7 Lock pin
2 Brake drum	8 Dust cover
3 Camshaft	9 Return spring
4 Anchor bracket	10 Shoe adjuster
5 Cam lever	11 Cam lever return spring
6 Bracket	12 Brake shoe assembly

PARKING BRAKE LEVER

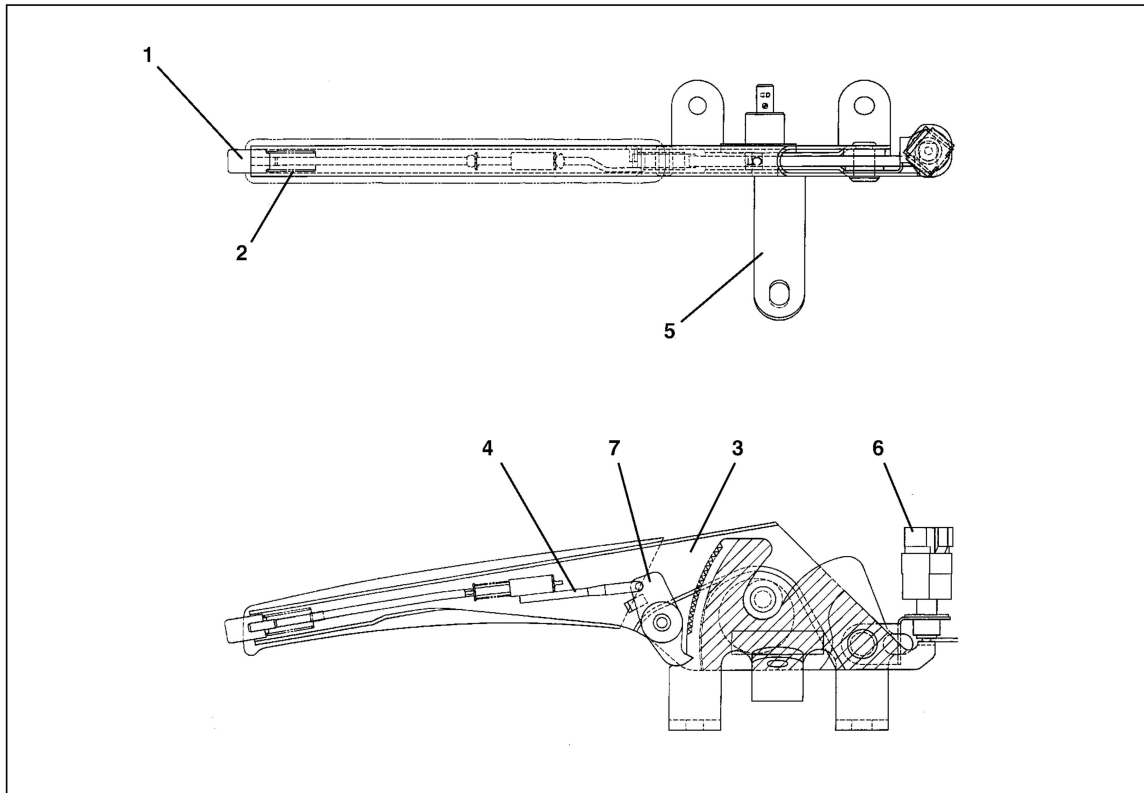

SHTS06Z080700002

1 Release rod knob	5 Brake lever bracket
2 Compression spring	6 Parking brake switch
3 Parking brake lever	7 Pawl
4 Pawl release rod	

Update Date : 2016-08-21 Print Date : 2020-02-27

BR07-4

PARKING BRAKE (MODEL: FC)

TROUBLESHOOTING

EN06Z0807F300001

Symptom	Possible cause	Remedy/Prevention
Too much play noted on parking brake lever	Excessively large drum-to-lining clearance.	Readjust the brake properly.
	Maladjusted control linkage.	Readjust.
Not enough braking force	Excessively large drum-to-lining clearance.	Readjust.
	Maladjusted control linkage.	Readjust.
	Burnt lining.	Repair or replace.
	Worn lining.	Replace.
	Shoes are too dirty with water, dust, etc.	Disassemble and clean.
	Linings are soaked with oil.	Replace.
Lining get burnt easily	Not enough drum-to-lining clearance.	Readjust.
	Shoe or drum is distorted.	Repair or replace.
	Springs are broken.	Replace.
Can not keep the lever in full stroke position	Over stroke of lever.	Adjust cable length.
	Wear or broken of ratchet.	Replace parts.
Not return the lever to running position, when cold weather. (below zero)	Water inside the cable (Frozen condition)	Replace the cable.

SPECIAL TOOL

EN06Z0807K100001

Prior to starting a parking brake adjustment, it is necessary to have the special tool.

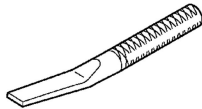
Illustration	Part number	Tool name	Remarks
	S0966-51130	BRAKE SHOE ADJUSTING TOOL	

COMPONENT LOCATOR

EN06Z0807D100001

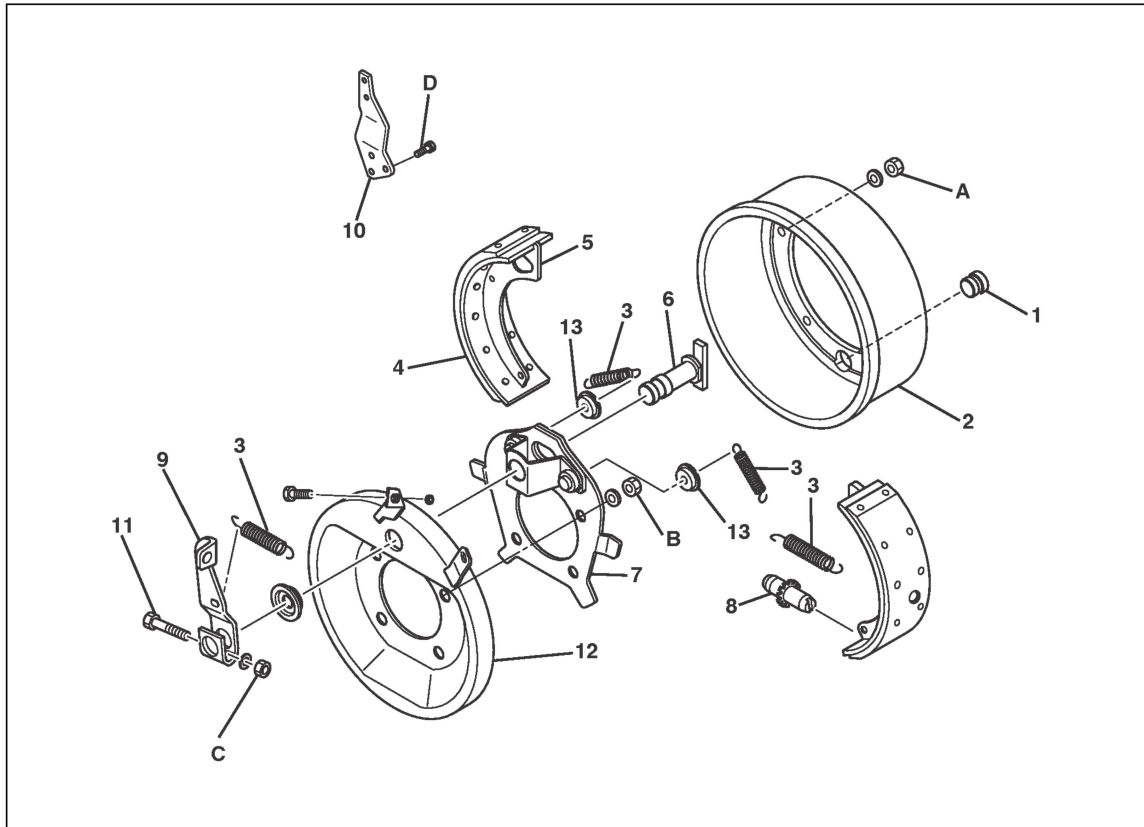

SHTS06Z080700004

1 Rubber plug	8 Shoe adjuster
2 Brake drum	9 Cam lever
3 Tension spring	10 Bracket
4 Brake lining	11 Lock pin
5 Brake shoe	12 Dust cover
6 Camshaft	13 Spacer
7 Anchor bracket	

Tightening torque

Unit: N·m {kgf·cm, lbf·ft}

A 64.5-85.5 {650-870, 48-63}	C 17.7-22.6 {180-230, 14-16}
B 147.5-166.5 {1,500-1,700, 109-122}	D 34.5-51.5 {351-525, 26-38}

Update Date : 2016-08-21 Print Date : 2020-02-27

BR07-6

PARKING BRAKE (MODEL: FC)

PARKING BRAKE CONTROL

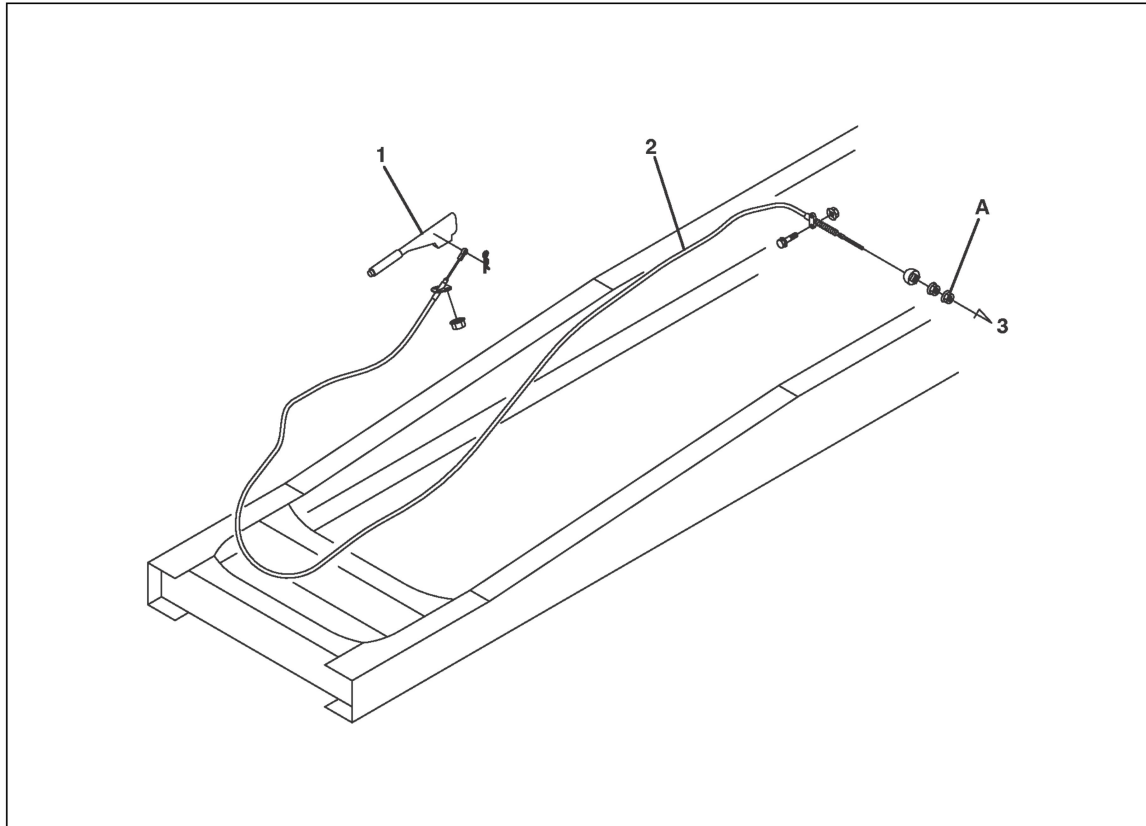

SHTS06Z080700005

1 Parking brake lever assembly	3 To parking brake
2 Cable	

Tightening torque	Unit: N·m {kgf·cm, lbf·ft}
A 18-26 {184-265, 13.3-19.1}	

PARKING BRAKE LEVER

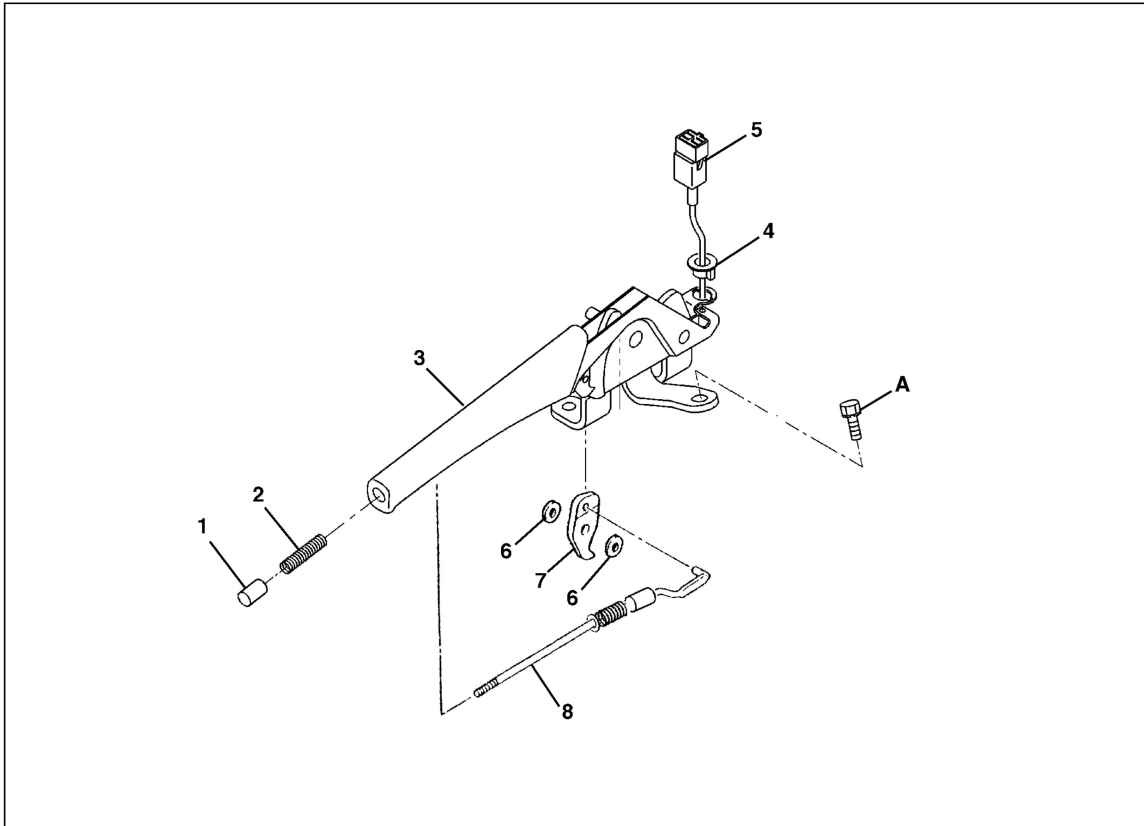

SHTS06Z080700006

1 Knob	5 Parking brake switch
2 Compression spring	6 Spacer
3 Lever assembly	7 Pawl
4 Bushing	8 Pawl release rod

Tightening torque

Unit: N·m {kgf·cm, lbf·ft}

A 14.0-32.0 {143-327, 10.34-23.65}	
---	--

OVERHAUL

EN06Z0807H200001

IMPORTANT POINTS - DISMOUNTING

1. **DISCONNECT THE PROPELLER SHAFT.**
(1) Refer to the chapter "PROPELLER SHAFT".
2. **REMOVE THE LOCK NUT AND TRANSMISSION OUTPUT SHAFT FLANGE.**
(1) Refer to the chapter "TRANSMISSION MAIN UNIT".

IMPORTANT POINTS - DISASSEMBLY

1. **REMOVE THE RETURN SPRING.**
(1) Use the suitable tool to remove the return spring.

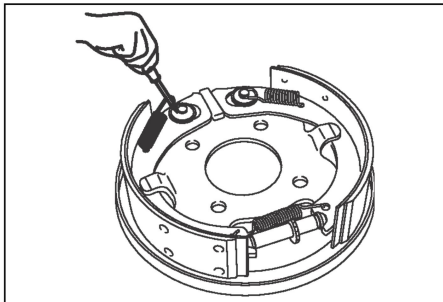

SHTS06Z080700007

2. **REMOVE THE CAM LEVER.**

NOTICE

Before removing the cam lever, make the aligning marks to cam lever and camshaft.

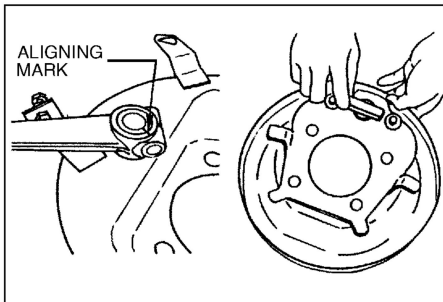

SHTS06Z080700008

IMPORTANT POINTS - ASSEMBLY

1. **INSTALL THE CAM LEVER.**

NOTICE

When installing the cam lever to camshaft, align the aligning marks which were applied at disassembly.

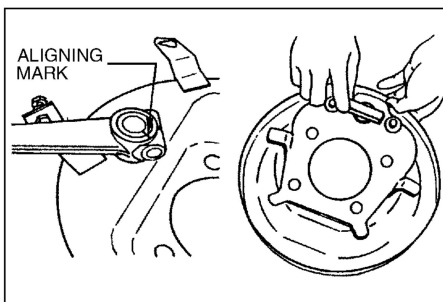

SHTS06Z080700008

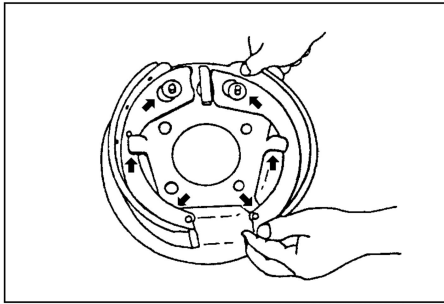

SHTS06Z080700009

2. LUBRICATION

- (1) Apply heat resistance grease on rubbing or matching faces of brake shoes, camshaft, shoe adjuster and position the adjuster in place.

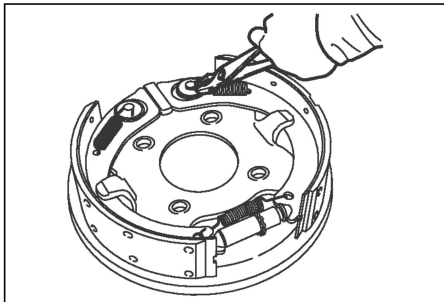

SHTS06Z080700010

3. INSTALL THE RETURN SPRING.

- (1) Use the suitable tool to install the return spring.

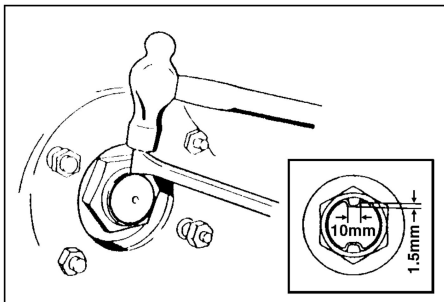

SHTS06Z080700011

4. INSTALL FLANGE YOKE COUPLING.

- (1) Install flange onto transmission output shaft and tighten lock nut.
Tightening torque: 587-783 N·m {6,000-8,000 kgf·cm, 434-578 lbf·ft}
- (2) Caulk rim part of nut into groove on output shaft.

NOTICE

- Caulked portion should be fitted in the groove thoroughly.
- Caulking should be done without rift.

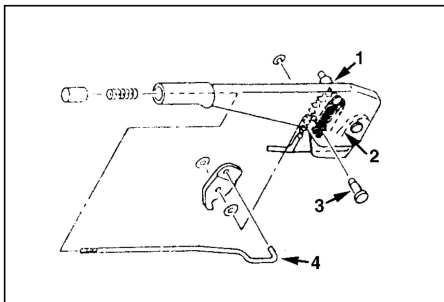

SHTS06Z080700012

5. APPLY BEARING GREASE ON THE FOLLOWING PARTS.

- (1) Pin (Cable)
- (2) Both sides of brake lever bracket
- (3) Pin (Pawl)
- (4) Pawl release rod

BR07-10

PARKING BRAKE (MODEL: FC)

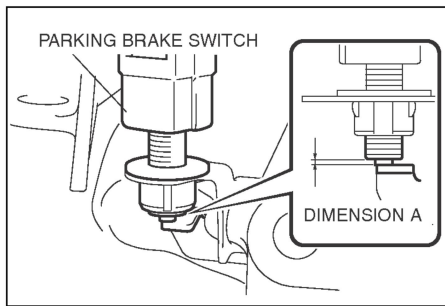

SHTS06Z080700013

6. PARKING BRAKE SWITCH.

- (1) Install the switch to the brake lever bracket.
- (2) Adjust the dimension A (Switch button projection) to 2.0 mm {0.0787 in.} when the parking brake lever is fully released.
- (3) Confirm the parking brake indicator lamp lights, when the lever is pulled by the notches.

INSPECTION AND REPAIR

EN06Z0807H300001

Unit: mm {in.}

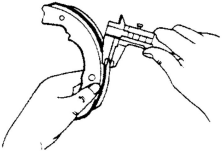
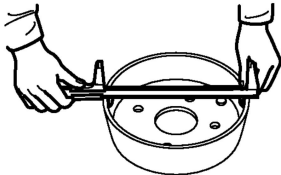
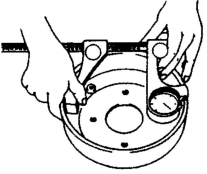
Inspection item	Standard	Limit	Remedy	Inspection procedure
Brake lining: Lining thickness	7.0 {0.2756}	4.0 {0.1575}	Replace.	Measure 
Brake drum: Inside diameter	254 {10.0}	256 {10.079}	Replace.	Measure 
Brake drum: Run out	0-0.1 {0-0.0039}	0.2 {0.0078}	Replace.	Measure 

ADJUSTMENT

EN06Z0807H300002

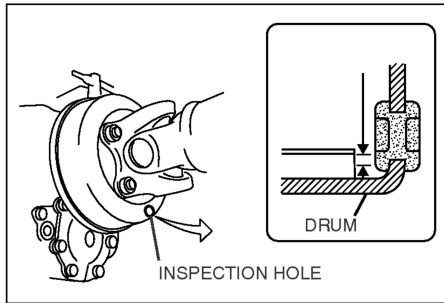

SHTS06Z080700017

1. CHECK THE REMAINING THICKNESS OF THE BRAKE LINING.

- (1) Measure the remaining thickness of lining through the inspection hole of brake drum. Replace the brake shoe assembly when it is worn to the service limit.

Assembly standard	Service limit
7.0 mm {0.276 in.}	4.0 mm {0.157 in.}

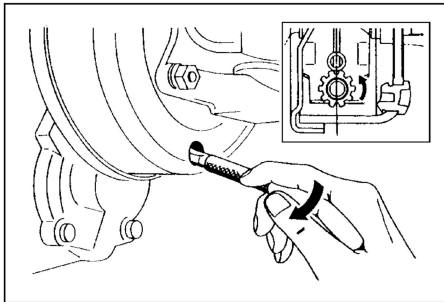

SHTS06Z080700018

2. ADJUST THE CLEARANCE BETWEEN DRUM AND LINING.

- (1) Lift the rear wheel to be adjusted off the ground.
- (2) Release the control lever.
- (3) Turn the adjuster to reduce the clearance to zero.
SST: Brake shoe adjusting tool (S0966-51130)

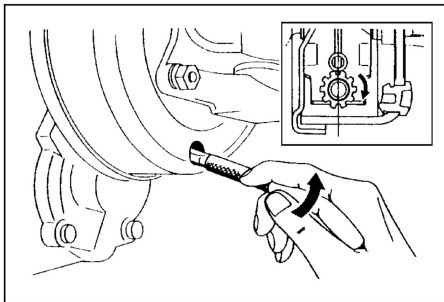

SHTS06Z080700019

- (4) Turn the adjuster backward by specified notches.

Specified notches: 14 notches

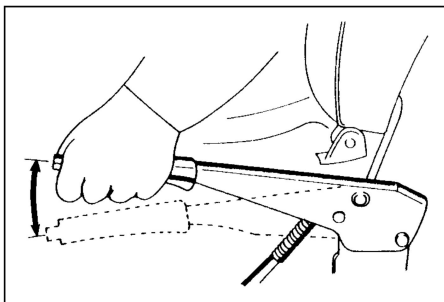

SHTS06Z080700020

- (5) Pull the parking brake lever fully to three times and release the lever. Turn the drum by hand to see that the shoes are not dragging. If there is any dragging, repeat the operation from step 1.

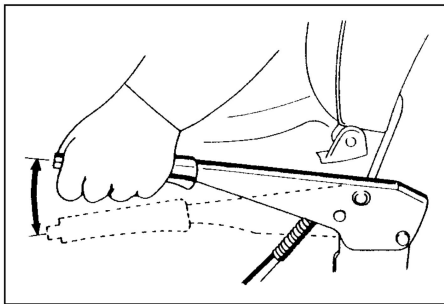

3. ADJUST THE CONTROL CABLE.

- (1) Pull the parking brake lever fully to three times and release the lever.

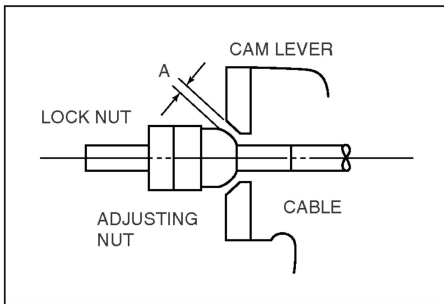

- (2) Adjust the clearance "A" between cable and cam lever on the parking brake to 1-2 mm {0.040-0.078 in.} by turning the adjusting nut.

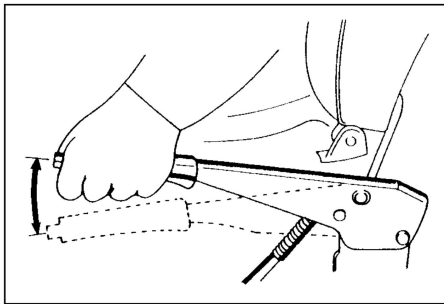

- (3) Pull the parking brake lever with 294 N {30 kgf, 66.14 lbf} force and make sure that the lever stroke is within assembly standard. Then lock the adjusting nut with the lock nut.
Assembly standard: 8-11 notches

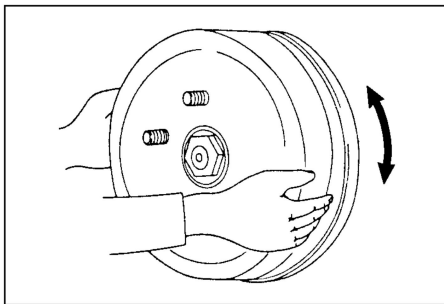

- (4) Pull the parking brake lever fully to three times and release the lever. Turn the drum by hand to see that the shoes are not dragging. If there is any dragging, repeat the operation from step 1.