



500 SERIES

FD 1124 MT SPRING



*Overseas model pictured.
May contain items not standard to the NZ model.

Japan 2016 Emission Levels
(pPNLT, Euro 6 Equivalent)

4 x 2 Cab Chassis

KEY FEATURES

- | | |
|---|--|
| ✓ Vehicle Stability Control (VSC)
– incl. ABS & TC | ✓ Euro 6 Equivalent Emissions |
| ✓ Pre-Collision System (PCS) | ✓ Lane Departure Warning System (LDWS) |
| ✓ SRS Airbag System (Driver) | ✓ ECE-R29 Cab Strength Certified |
| ✓ Engine Retarder Brake (Jake Brake) | ✓ Adaptive Cruise Control (ACC) |

KEY SPECIFICATIONS

GVM	11,000kg
GCM	20,000kg
Power	240hp / 177kW
Torque	794Nm
Transmission	6 Speed Manual
Wheelbase	4.3m, 4.9m

ENGINE

Model	HINO A05C-TE
Max. Output (ISO NET)	240hp / 177kW @ 2,300 RPM
Max. Torque (ISO NET)	794Nm @ 1,400 RPM
Max. Engine RPM	2,550 RPM
Engine Compliance	ADR 80/03 using Japan 2016 pPNLT (Euro 6 Equivalent Emissions)
Type	Diesel, turbocharged and intercooled 4 cylinder with overhead camshaft
Combustion System	Direct injection with EGR
Bore & Stroke	112 x 130mm
Piston Displacement	5.123L
Compression Ratio	17.0:1
Fuel Injection	Electronic control common rail
Air Compressor / Bore & Stroke	Single cylinder, 70 x 40mm
Air Cleaner	Dual paper elements
Exhaust	Horizontal outlet RHS
Emission Control System	DPR & SCR (AdBlue®)
Engine Immobiliser	Equipped

PERFORMANCE

Calculations based on 11,000kg GVM with 235/75R17.5 tyres

Engine RPM @ 100km/h	2,374
Max. Theoretical Speed (km/h)	108
Gradeability Tan (%) @ GVM	55.8

BRAKES

Type	Drum brakes front and rear	
Control	Air Over Hydraulic (AOH), dual circuit	
Drum Diameter x Lining Width	Front	320 x 110mm
	Rear	320 x 120mm
Air Dryer	Equipped	
Vehicle Stability Control (VSC)	Equipped	
Pre-Collision System (PCS)	Equipped	
Anti-Lock Brake System (ABS)	Equipped	
Traction Control (TC)	Equipped	
Park Brake	Spring brake acting on rear wheels	
Exhaust & Engine Brake (Jake Brake)	Equipped	
Easy Start Hill Assist (ES)	Equipped	

ELECTRICAL

Type	24V negative earth
Batteries	2 x 12V 120Ah 115F51
Alternator Capacity	24V x 90A
Starter Type	24V x 4.5kW
Headlamps	LED main beam with LED daytime running lamps
LED Cornering / Fog Lamps	Equipped
LED Interior & Reading Lamp	Equipped
Electric Air Horn	Equipped
CANBUS Connected	Equipped J1939 protocol (see BMM for details)

POWER & TORQUE CHART (ISO NET) A05C-TE

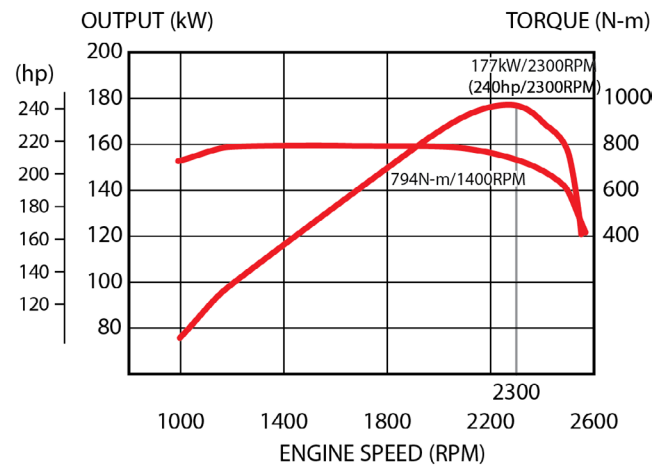

TRANSMISSION & GEAR RATIOS

Make & Description	Hino LX06S, 6 Speed Synchromesh with Cable Shift & Air Assist	
Type	Overdrive	
Gear Ratios	1	6.098
	2	3.858
	3	2.340
	4	1.422
	5	1
	6	0.744
Reverse	5.672	
Rear Axle Ratio	4.625	
PTO Option / Torque Capacity	Single / 245Nm	

CLUTCH

Model	CSP-350
Type	Dry single plate
Clutch plate	350mm Organic
Control	Hydraulic with Air Booster

FUEL TANK & SUPPLY

Material	Steel
Fuel Capacity	200L
Lockable Fuel Cap	Equipped
Prefilter & Sedimenter	Equipped
AdBlue® Capacity	19L

STEERING

Type	Telescopic tilt steering column, recirculating ball, integral power steering	
Gear Ratio	19.0:1	
Steering Angles	Inside – 53°	Outside – 38°

SAFETY FEATURES

Active Safety Features	
Vehicle Stability Control (VSC)	Equipped
Anti-Lock Brake System (ABS)	Equipped
Pre-Collision System (PCS)	Equipped
PCS is inclusive of	Safety Eye (SE) Autonomous Emergency Braking (AEB) Pedestrian Detection (PD)
Traction Control (TC)	Equipped
Lane Departure Warning System (LDWS)	Equipped
Staggering Warning (SW)	Equipped
Adaptive Cruise Control (ACC)	Equipped
Reverse Camera (RC)	Equipped
Easy Start Hill Assist (ES)	Equipped
Passive Safety Features	
SRS Airbag	Equipped (for driver)
SRS Seat Belt Pretensioner	Equipped (for driver)
Front Underrun Protection Device (FUPD)	Equipped
ECE-R29 Cab Strength Certified	Equipped

AXLE, SUSPENSION & LOAD LIMITS

Front	Front Axle Model	LF 456		
	Front Axle Type	I-Beam, Reverse Elliot		
	Front Suspension Type	Taper leaf springs with shock absorbers and stabiliser		
	Spring Dimensions	1,300 x 70mm		
	Number	3		
	Spring Rate (kgf/mm ²)	23		
	Axle Limit (incl. Suspension)	4,100kg		
Rear	Tyre Limit	4,000kg		
	Rear Axle Model	SH13		
	Rear Axle Type	Fully floating, single reduction by hypoid gears		
	Rear Suspension Type	Multi leaf and auxiliary with shock absorbers		
	Suspension Dimensions	Main	Auxiliary	
		Length x Width (mm)	1,300 x 70mm	900 x 70mm
	Number	8	9	
	Spring Rate (kgf/mm ²)	25	74	
	Axle Limit (incl. Suspension)	7,000kg		
	Tyre Limit	7,600kg		

CHASSIS FRAME

Model	FD2AJ	FD2AL
Main Section (depth x flange x thickness)	228.4 x 73 x 5.2mm	231.6 x 73 x 6.8mm
Chassis Width	820mm	
Tensile Strength	540 N/mm ² (55 kgf/mm ²)	
Tow Hook (Front & Rear)	2,000 kgf (max angle of 15°)	
Type	Ladder-shaped channel section side rails	

CAB DETAILS

Type	Forward control, rest cab, all steel construction with torsion bar tilt mechanism
Grille Colour	Matte grey
ADR 42 Sleeper Berth	Compliant
Seating Capacity	3
Driver's Seat	ISRI 6860 NTS2 air suspension, 10 way adjustable with integrated safety belt and rear pocket
Side Passenger Seat	High back and reclining seat
Centre Seat	Foldaway type with integrated tray
Seat Belts	3 point lap sash for driver and side passenger, 2 point lap for centre position
Sunvisor & Overhead Console	Equipped (for driver and side passenger)
Windscreen Wipers	2 arm wiper and washers, 2 speed with intermittent
Cab Heater & Air Conditioner	Equipped with 4 speed fan
Auxiliary Power Supply	12V x 120W socket and USB 2.1A
Rear-View Mirrors	External: Electric and heated, 2 flat type, 2 convex spotters and kerb view
Floor Covering	Vinyl type
Central Locking & Keyless Entry	Equipped with immobiliser
Cab Storage Pockets	Equipped in both side doors
Power Windows	Equipped
Foot Rest	Equipped
Cup Holders	3 centre and 2 door beverage holders
Multimedia System	6.5" LCD, HD touch screen display with DAB+ AM/FM radio, AUX input, Bluetooth® 4.1, Android 6.0, CAN bus connected, and Wi-Fi enabled

INSTRUMENTATION

LCD Display	Meters & Gauges
✓ Date, Day, & Time	✓ Speedometer
✓ Temperature Gauge	✓ Tachometer
✓ Fuel & AdBlue® Gauges	✓ Air Gauges
✓ Odometer & Hour Meter	Additional Switches & Controls
Multi Information Display (MID)	✓ External Flat Mirror Control
✓ General Information	✓ VSC, PCS, & LDWS Off
✓ Cruise Control	✓ Idle Up & Quick Warm Up
✓ Eco Tree	✓ Mirror Heater
✓ Display Setting	✓ Engine Brake
✓ Safe Driving Settings	✓ DPR Regeneration
✓ System Check	✓ Electric Window Lock Out
Steering Wheel & Column Controls	✓ Headlight Leveller
✓ Cruise Control	✓ Hazard Lights
✓ MID Controls	✓ ES Start Control
✓ Headlights, Indicators, Window Wipers	✓ ECO Run

WHEELS & TYRES

Wheel Type	6 stud disc wheel (JIS type) PCD 222.25
Rim Size	6.75" x 17.5" / 135mm offset (alloy)
Tyre Size	235/75R17.5 132/130
Number of Tyres	7 incl. spare
Spare Tyre Carrier	Equipped

HINO 500 SERIES - FD 1124 MT SPRING

DIMENSIONS (MM)

Model	FD2AJ1A-DBC AE	FD2AL1A-DBC AE
Product Code	FD 1124 MT SPRING 4290	FD 1124 MT SPRING 4890
Suspension	Leaf	
Wheelbase (WB)	4,290	4,890
Overall Length (OL)	7,285	8,135
Overall Width (OW)	2,190	
Overall Height (OH)	2,450	
Cab to Axle Centre (CA)	3,365	3,965
Front Overhang (FOH)	1,145	
Rear Overhang (ROH)	1,810	2,060
Rear Chassis Height (RCH) – at axle	860	
Front Track (FT)	1,780	
Rear Track (RT)	1,660	
Kerb to Kerb	13,600	15,400
Wall to Wall	15,000	16,800
Indicative Chassis Mass (kg) – with 10L of fuel, no tools or spare tyre, and subject to a $\pm 3\%$ tolerance		
Total	3,435	3,520
Front	2,335	2,390
Rear	1,090	1,130
GVM	11,000	
GCM	20,000	

CHASSIS DRAWINGS (PLEASE REFER TO DIMENSIONS TABLE ABOVE)

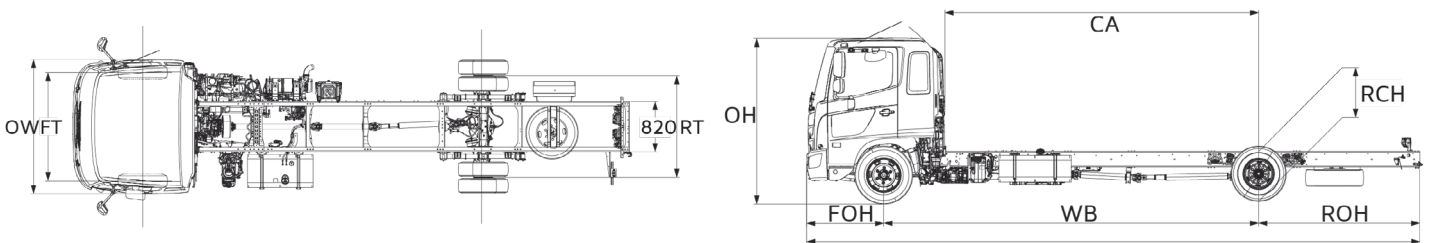

Drawings are for reference only to the table. For specific chassis layouts and dimensions, please refer to Body Mounting Manual drawings.

WARRANTY (PLEASE REFER TO HDL WARRANTY CONDITIONS)

Standard Warranty	Engine & Powerlines
24 months or 100,000kms (whichever comes first)	36 months or 150,000kms (whichever comes first)

DISCLAIMER

Hino Trucks are distributed in New Zealand by Hino Distributors (NZ) Ltd.

All efforts have been made to ensure the information contained in this brochure was correct at time of printing or uploading. Hino Distributors (NZ) Ltd reserves the right to alter any details of the specifications and equipment without notice. Hino in so far as it is permitted by law to do so, shall not be liable in any way as a result of any reliance placed by any person on anything contained in this brochure. You should therefore check with your authorised Hino dealer at the time of ordering your motor vehicle to ensure that colour, specifications, equipment, design features and options are available for the vehicle you are ordering. Please note that some options may only be available in combination with others. Authorised Hino dealers will on request provide up to date information on all accessories, design features, prices and availability.